



Features

- Low forward voltage drop
- Soft recovery
- Hermetic metal cases with ceramic insulators

Typical Applications

- Inverters and choppers
- Motor control
- Snubber and free-wheeling diodes

Part No. Y76ZKD-ZT73cT

I_{F(AV)}	2570A
V_{RRM}	2200V 2500V 2800V 3000V

SYMBOL	CHARACTERISTIC	TEST CONDITIONS	T _J (°C)	VALUE			UNIT	
				Min	Type	Max		
I _{F(AV)}	Mean forward current	180° half sine wave 50Hz Double side cooled, T _C =85°C	150			2570	A	
V _{RRM}	Repetitive peak reverse voltage	tp=10ms	150	2100		3000	V	
I _{R(RM)}	Repetitive peak current	at V _{RRM}	150			200	mA	
I _{FSM}	Surge forward current	10ms half sine wave	150			23	kA	
I ² t	I ² t for fusing coordination	V _R =0.6V _{RRM}					2645	A ² s*10 ³
V _{FO}	Threshold voltage		150			1.20	V	
r _F	Forward slope resistance					0.21	mΩ	
V _{FM}	Peak forward voltage	I _{FM} =3000A, F=35kN	150			1.90	V	
I _{rm}	Reverse recovery current		150		300		A	
t _{rr}	Reverse recovery time	I _{FM} =2000A, tp=4000μs, di/dt=-60A/μs, V _R =100V				5		μs
Q _{rr}	Recovery charge					750		μC
R _{th(j-c)}	Thermal resistance Junction to case	Double side cooled Clamping force 40kN				0.010	°C/W	
R _{th(c-h)}	Thermal resistance case to heat sink					0.003		
F _m	Mounting force			35		47	kN	
T _{vj}	Junction temperature			-40		150	°C	
T _{stg}	Stored temperature			-40		160	°C	
W _t	Weight				1100		g	
Outline	ZT73cT							

Outline:

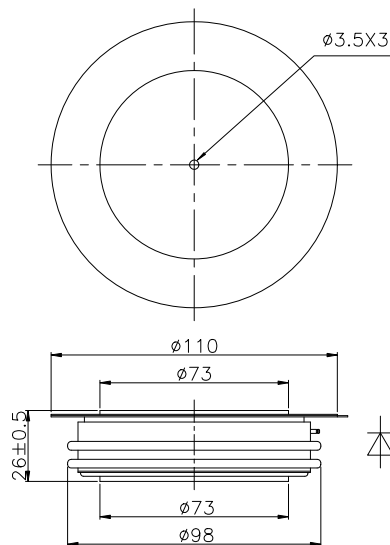

TECHSEM reserves the right to change specifications without notice.